



FEATURES

- Universal 85 - 305VAC or 120 - 430VDC Input voltage
- Accepts AC or DC input (dual-use of same terminal)
- Operating ambient temperature range: -40°C to +85°C
- High I/O Isolation test voltage up to 4000VAC
- Low ripple & noise
- Output short circuit, over-current, over-voltage, over-temperature protection
- DIN rail TS-35/7.5 or 15 mountable
- Suitable for small chassis and narrow space installation
- Safety according to UL61010, EN/UL/BS EN62368, EN60335, EN61558, GB4943

LI75-23BxxR3 is Mornsun AC-DC converter series featuring a cost-effective, energy efficient green power supply solution for standard DIN-rail mounting. The products offer a high level of stability and immunity to noise for industrial control equipment, machinery, and other industrial equipment in a variety of harsh environments. These light weight AC-DC converters have an extremely compact design and the standard rail installation for space saving. With good EMC performance, compliant with international UL61010, EN/UL/BS EN62368, EN60335, EN61558, GB4943 standards for EMC and safety.

Selection Guide

| Part No.* | Output Power (W) | Nominal Output Voltage and Current (Vo/Io) | Output Voltage Adjustable Range (V) | Efficiency at 230VAC (%) Typ. | Max. Capacitive Load (µF) |
|--------------|------------------|--|-------------------------------------|-------------------------------|---------------------------|
| LI75-23B12R3 | 75.6 | 12V/6.3A | 12-14V | 88 | 6000 |
| LI75-23B24R3 | 76.8 | 24V/3.2A | 24-28V | 90 | 1500 |
| LI75-23B48R3 | | 48V/1.6A | 48-53V | 91 | 1000 |

Note: *Use suffix "Q" for conformal coating.

Input Specifications

| Item | Operating Conditions | Min. | Typ. | Max. | Unit |
|-------------------------|----------------------|-------------|------|------|------|
| Input Voltage Range | AC input | 85 | -- | 305 | VAC |
| | DC input | 120 | -- | 430 | VDC |
| Input Voltage Frequency | | 47 | -- | 63 | Hz |
| Input Current | 115VAC | -- | -- | 2 | A |
| | 230VAC | -- | -- | 1 | |
| Inrush Current | 115VAC | Cold start | 30 | -- | |
| | 230VAC | | 50 | -- | |
| Leakage Current | 277VAC, 60Hz | <0.5mA | | | |
| Hot Plug | | Unavailable | | | |

Output Specifications

| Item | Operating Conditions | Min. | Typ. | Max. | Unit |
|-------------------------|----------------------|---------|------|------|------|
| Output Voltage Accuracy | Full load range | 12V | ±2.0 | -- | % |
| | | 24V/48V | ±1.0 | -- | |
| Line Regulation | Rated load | -- | ±0.5 | -- | |
| Load Regulation | 0% - 100% load | -- | ±1.0 | -- | |
| Ripple & Noise* | 20MHz bandwidth | 12V | 80 | -- | mV |

| | | | | | | |
|--|--|-----------------------------------|---|-------|-----|------|
| | (peak-to-peak value) | 24V | -- | 120 | -- | |
| | | 48V | -- | 150 | -- | |
| Temperature Coefficient | | | -- | ±0.03 | -- | %/°C |
| Minimum Load | | | 0 | -- | -- | % |
| Stand-by Power Consumption | 115VAC | | -- | 0.5 | 1.0 | W |
| | 230VAC | | -- | 1.0 | 1.5 | |
| Hold-up Time | 115VAC | | -- | 12 | -- | ms |
| | 230VAC | | -- | 60 | -- | |
| Short Circuit Protection | Recovery time <5s after the short circuit disappear. | | Constant current mode, continuous, self-recover | | | |
| Over-current Protection | 230VAC, rated load | Normal temperature | 110% Io - 150% Io, self-recover | | | |
| | | High temperature, low temperature | ≥105% Io, self-recover | | | |
| Over-voltage Protection | 12V | | ≤17VDC (Hiccup, self-recover) | | | |
| | 24V | | ≤33VDC (Hiccup, self-recover) | | | |
| | 48V | | ≤60VDC (Hiccup, self-recover) | | | |
| Over-temperature Protection | 230VAC, rated load | | Output voltage turn off, self-recover after the temperature drops | | | |
| Note: *The "Tip and barrel method" is used for ripple and noise test, output parallel 47uF electrolytic capacitor and 0.1uF ceramic capacitor, please refer to Enclosed Switching Power Supply Application Notes for specific information. | | | | | | |

General Specifications

| Item | Operating Conditions | | Min. | Typ. | Max. | Unit |
|-----------------------|--------------------------------|---|------|------|------|---------|
| Isolation Test | Input - ⊕ | Electric strength test for 1min., leakage current <10mA | 2000 | -- | -- | VAC |
| | Input - output | | 4000 | -- | -- | |
| | Output - ⊕ | | 500 | -- | -- | |
| Insulation Resistance | Input - ⊕ | At 500VDC | 50 | -- | -- | MΩ |
| | Input - output | | 50 | -- | -- | |
| | Output - ⊕ | | 50 | -- | -- | |
| Operating Temperature | | -40 | -- | +85 | °C | |
| Storage Temperature | | -40 | -- | +85 | | |
| Operating Humidity | Non-condensing | 10 | -- | 95 | %RH | |
| Storage Humidity | | 20 | -- | 95 | | |
| Switching Frequency | | -- | 65 | -- | kHz | |
| Power Derating | Operating temperature derating | -40°C to -30°C | 5 | -- | -- | % / °C |
| | | +45°C to +85°C | 2 | -- | -- | |
| | Input voltage derating | 85VAC - 100VAC | 2 | -- | -- | % / VAC |
| | | 277VAC - 305VAC | 0.71 | -- | -- | |
| Safety Standard | | Design refer to UL61010-1, EN60335-1, GB4943.1, IEC/EN/UL/BS EN62368-1, IEC/EN61558-1 | | | | |
| Safety Class | | CLASS I | | | | |
| MTBF | MIL-HDBK-217F@25°C | ≥300,000 h | | | | |

Mechanical Specifications

| | |
|----------------|------------------------------|
| Case Material | Metal (AL1100, SGCC) |
| Dimensions | 110.00mm x 87.50mm x 32.00mm |
| Weight | 340g (Typ.) |
| Cooling Method | Free air convection |

Electromagnetic Compatibility (EMC)

| | | | | |
|-----------|---|------------------|---------------------------------------|------------------|
| Emissions | CE | CISPR32/EN55032 | CLASS B | |
| | RE | CISPR32/EN55032 | CLASS B | |
| | Harmonic current | IEC/EN61000-3-2 | CLASS A | |
| Immunity | ESD | IEC/EN 61000-4-2 | Contact ±6KV/Air ±8KV | perf. Criteria A |
| | RS | IEC/EN 61000-4-3 | 10V/m | perf. Criteria A |
| | EFT | IEC/EN 61000-4-4 | ±2KV | perf. Criteria A |
| | Surge | IEC/EN 61000-4-5 | line to line ±2KV/line to ground ±4KV | perf. Criteria A |
| | CS | IEC/EN61000-4-6 | 10 Vr.m.s | perf. Criteria A |
| | MS | IEC/EN61000-4-8 | 30A/m | perf. Criteria A |
| | Voltage dips, short interruptions and voltage variations immunity | IEC/EN61000-4-11 | 0%, 70% | perf. Criteria B |

Product Characteristic Curve

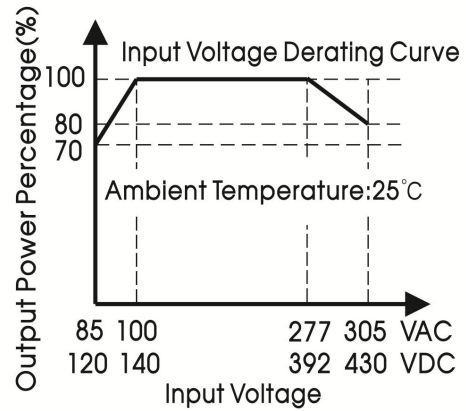
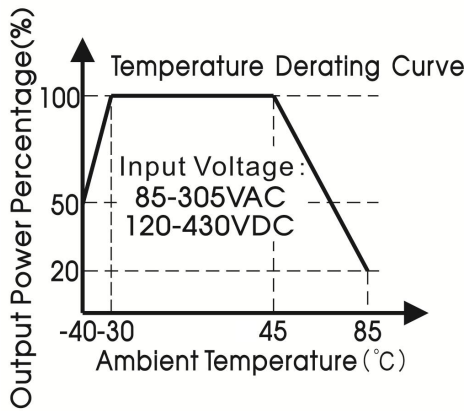

- Note: 1. With an AC input voltage between 85 - 100VAC/277 - 305VAC and a DC input between 120 - 140VDC/392 - 430VDC the output power must be derated as per the temperature derating curves;
 2. This product is suitable for applications using natural air cooling; for applications in closed environment please consult Mornsun FAE.

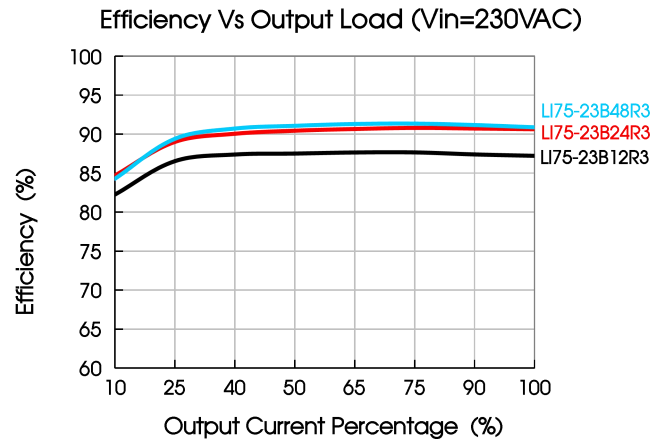
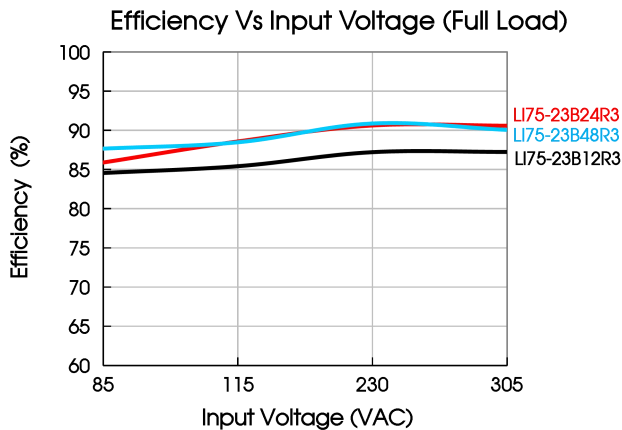

Installation Diagram

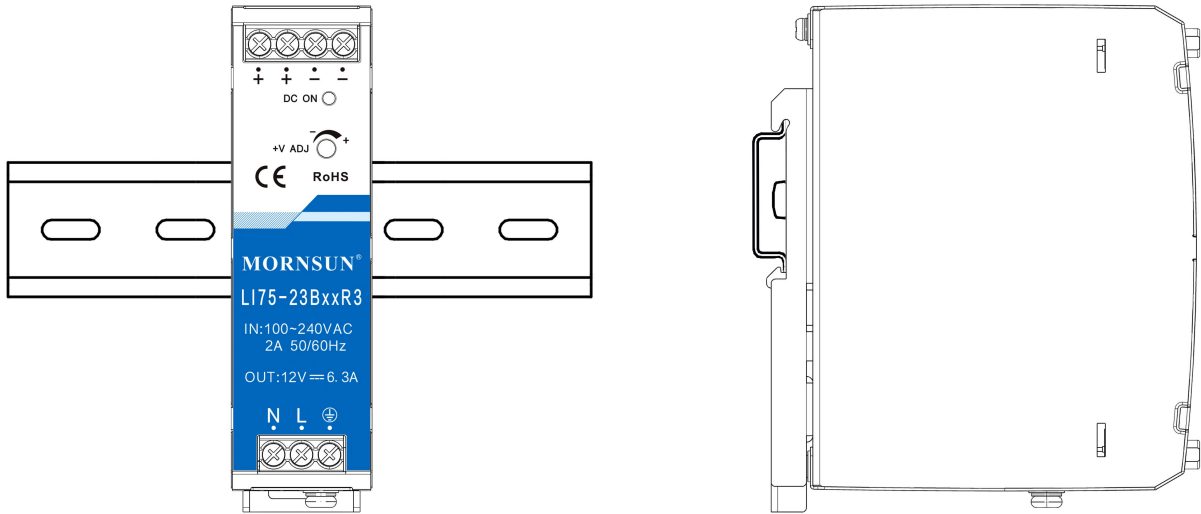

Note: Keep the following installation clearances: 20mm on top, 20mm on the bottom, 5mm on the left and right sides are recommended when the device is loaded permanently with more than 50% of the rated power. Increase this clearance to 15mm in case the adjacent device is a heat source (e.g. another power supply).

Dimensions and Recommended Layout

THIRD ANGLE PROJECTION

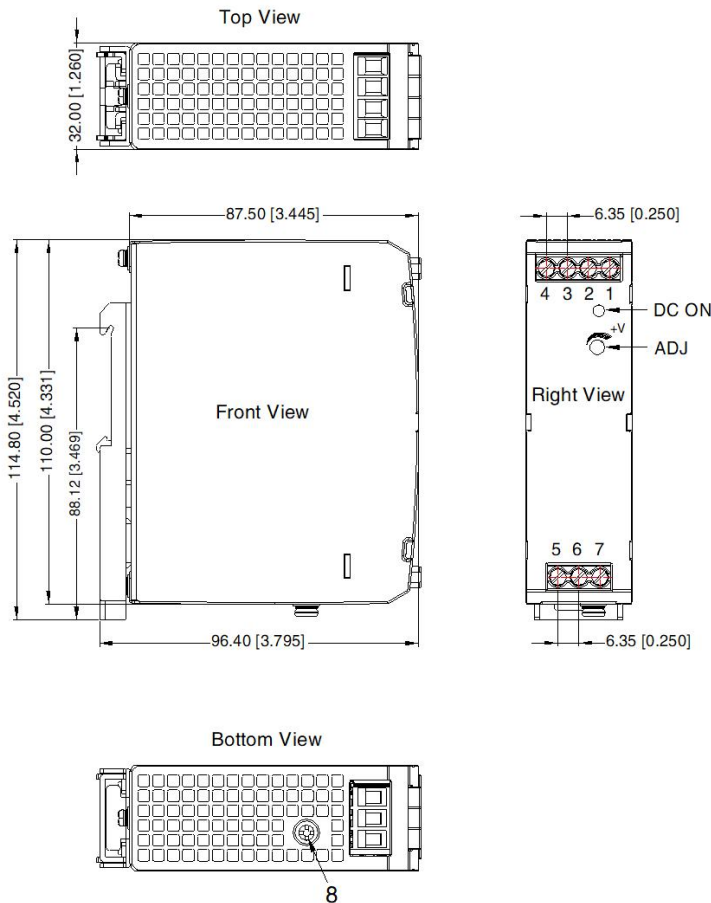

| Pin-Out | |
|---------|-------|
| Pin | Mark |
| 1 | -Vo |
| 2 | -Vo |
| 3 | +Vo |
| 4 | +Vo |
| 5 | AC(N) |
| 6 | AC(L) |
| 7 | |

7, 8 any position must be connected to the earth ()

Note:
Unit: mm[inch]
ADJ: Output adjustable resistor
Wire range: 26-10 AWG
Tightening torque: Max 0.4 N-m
Mounting rail: TS35, rail needs to connect safety ground
General tolerances: $\pm 1.00[\pm 0.039]$

Note:

1. For additional information on Product Packaging please refer to www.mornsun-power.com. Packaging bag number: 58220280;
2. Unless otherwise specified, parameters in this datasheet were measured under the conditions of $T_a=25^{\circ}\text{C}$, humidity <75% RH with nominal input voltage and rated output load;
3. The room temperature derating of $5^{\circ}\text{C}/1000\text{m}$ is needed for operating altitude greater than 2000m;
4. All index testing methods in this datasheet are based on our company corporate standards;
5. In order to improve the efficiency at high input voltage, there will be audible noise generated, but it does not affect product performance and reliability;
6. We can provide product customization service, please contact our technicians directly for specific information;
7. Products are related to laws and regulations: see "Features" and "EMC";
8. The out case needs to be connected to PE (\perp) of system when the terminal equipment in operating;
9. The output voltage can be adjusted by the ADJ, clockwise to increase;
10. Our products shall be classified according to ISO14001 and related environmental laws and regulations, and shall be handled by qualified units;
11. The power supply is considered a component which will be installed into a terminal equipment. All EMC tests should be confirmed with the final equipment. Please consult our FAE for EMC test operation instructions.

Mornsun Guangzhou Science & Technology Co., Ltd.

Address: No. 5, Kehui St. 1, Kehui Development Center, Science Ave., Guangzhou Science City, Huangpu District, Guangzhou, P. R. China

Tel: 86-20-38601850

Fax: 86-20-38601272

E-mail: info@mornsun.cn

www.mornsun-power.com